

Lower Thames Crossing

6.2 Environmental Statement Figures

Figure 8.2 - Phase 1 Habitat Map

APFP Regulation 5(2)(a)
Infrastructure Planning
(Applications: Prescribed Forms and Procedure)
Regulations 2009
Volume 6

DATE: October 2022

Planning Inspectorate Scheme Ref: TR010032
Application Document Ref: TR010032/APP/6.2

VERSION: 1.0

Legend

Phase 1 - Lines

- ● A3.1 - Broad-leaved scattered trees
- ● A3.2 - Coniferous scattered trees
- ● A3.3 - Mixed scattered trees
- F2.1 - Marginal vegetation
- G1 - Standing water
- G2 - Running water
- W W J2.1.1 - Intact hedge - native species-rich
- J2.1.2 - Intact hedge - species-poor
- W W J2.2.1 - Defunct hedge - native species-rich
- J2.2.2 - Defunct hedge - species-poor
- W W J2.3.1 - Hedge and trees - native species-rich
- H H H J2.3.2 - Hedge and trees - species-poor
- H H H J2.4 - Fence
- J2.5 - Wall
- - J2.6 - Dry ditch
- ● J2.8 - Earth bank
- |||| J3.5 - Sea wall
- J5 - Other habitat

Phase 1 - Polygons

- A1.1.1 - Broad-leaved semi-natural woodland
- A1.1.2 - Broad-leaved plantation woodland
- A1.2.2 - Coniferous plantation woodland
- A1.3.2 - Mixed plantation woodland
- A2.1 - Dense/continuous scrub
- F A4.1 - Recently-felled broad-leaved woodland
- B1.1 - Unimproved acid grassland
- SI B1.2 - Semi-improved acid grassland
- B2.1 - Unimproved neutral grassland
- SI B2.2 - Semi-improved neutral grassland
- B3.1 - Unimproved calcareous grassland
- SI B3.2 - Semi-improved calcareous grassland
- I B4 - Improved grassland
- B5 - Marsh/marshy grassland
- SI B6 - Poor semi-improved grassland
- C1.1 - Continuous bracken
- C3.1 - Tall ruderal
- C3.2 - Non-ruderal
- F1 - Swamp
- G1 - Standing water
- G2 - Running water
- H1.1 - Intertidal mud/sand
- H1.2 - Intertidal shingles/cobbles
- H1.3 - Intertidal boulders/rocks
- H2.6 - Dense/continuous saltmarsh
- H3 - Shingle above high tide mark
- Q I2.1 - Quarry
- S I2.2 - Spoil
- R I2.4 - Refuse tip
- A J1.1 - Arable
- A J1.2 - Amenity grassland
- X J1.3 - Ephemeral/short perennial
- J1.4 - Introduced shrub
- J3.4 - Caravan site
- J3.6 - Buildings
- J4 - Bare ground
- J5 - Other habitat
- Hardstanding

Contains Ordnance Survey data. © Crown copyright and database rights 2022. Ordnance Survey 100030649

P02	S8	06/10/2022	DCO Application	CD	SM	BF
Rev	Status	Rev. Date	Purpose of revision	Drawn	Chkd	Apprv'd

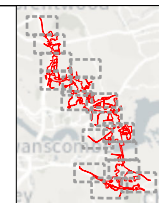

Client

Project
LOWER THAMES CROSSING

Status	DCO APPLICATION		Original Size	A3	Revision	P02
Application Document Number	TR010032/APP/6.2		Scale	N/A		
Drawing Title	Figure 8.2 - Phase 1 Habitat Map Legend					
Drawing Number	HE540039-CJV-EBD-SZP_EGNE00000000-DR-LE-50040					

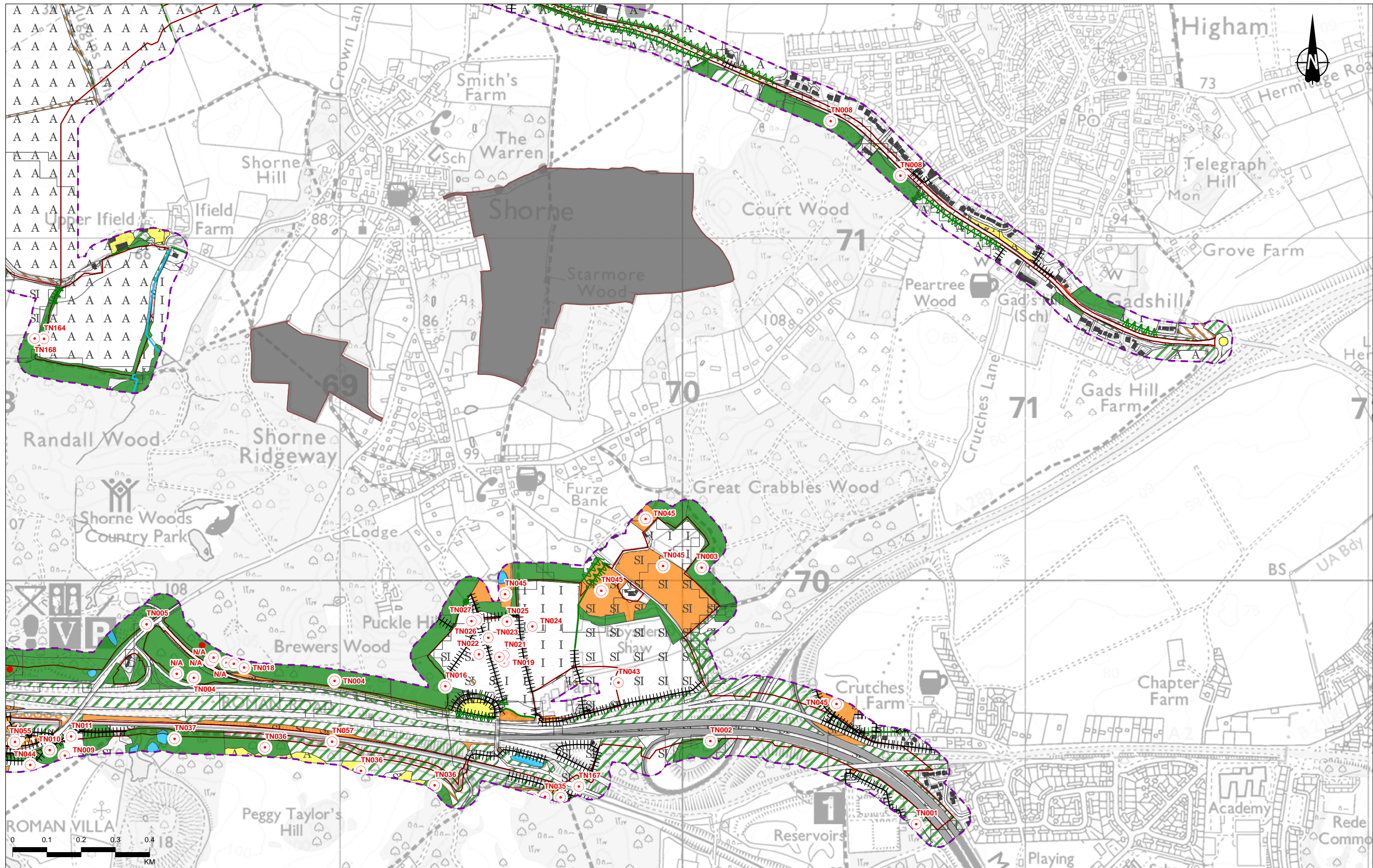

Contains Ordnance Survey data. © Crown copyright and database rights 2022. Ordnance Survey 100030649

Rev	Status	Rev. Date	Purpose of revision	Drawn	Chkd	Apprvd
P02	S8	06/10/2022	DCO Application	CD	SM	BF

Legend

- Order Limits
- Compensation area for nitrogen deposition
- Plants and habitats study area
- Target note
- Invasive species

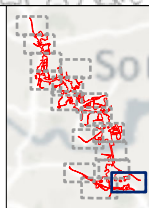

Client: **national highways**

Project: **LOWER THAMES CROSSING**

Status	DCO APPLICATION	Original Size	A3	Revision	P02
Application Document Number	TR010032/APP/6.2	Scale	1:10,000		
Drawing Title	Figure 8.2 - Phase 1 Habitat Map Page 1 of 16				
Drawing Number	HE540039-CJV-EBD-SZP_EGNE0000000-DR-LE-50040				

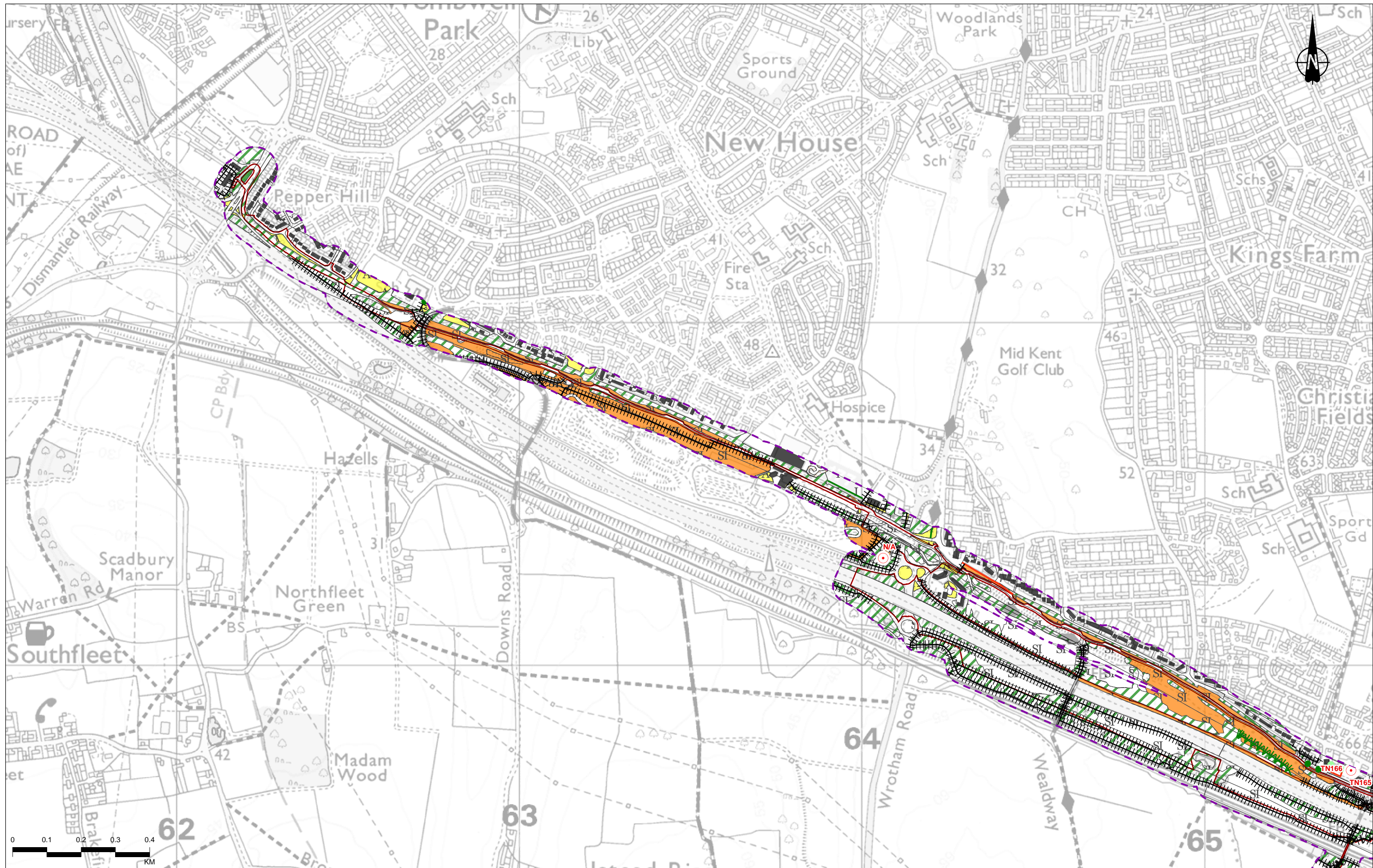



Contains Ordnance Survey data. © Crown copyright and database rights 2022. Ordnance Survey 100030649

Rev	Status	Rev. Date	Purpose of revision	Drawn	Chkd	Apprv'd
P02	S8	06/10/2022	DCO Application	CD	SM	BF

Legend

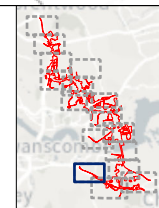
- Order Limits
- Compensation area for nitrogen deposition
- Plants and habitats study area
- Target note
- Invasive species



Client

 Project
LOWER THAMES CROSSING

Status	DCO APPLICATION	Original Size	A3	Revision	P02
Application Document Number	TR010032/APP/6.2	Scale	1:10,000		
Drawing Title	Figure 8.2 - Phase 1 Habitat Map Page 3 of 16				
Drawing Number	HE540039-CJV-EBD-SZP_EGNE00000000-DR-LE-50040				

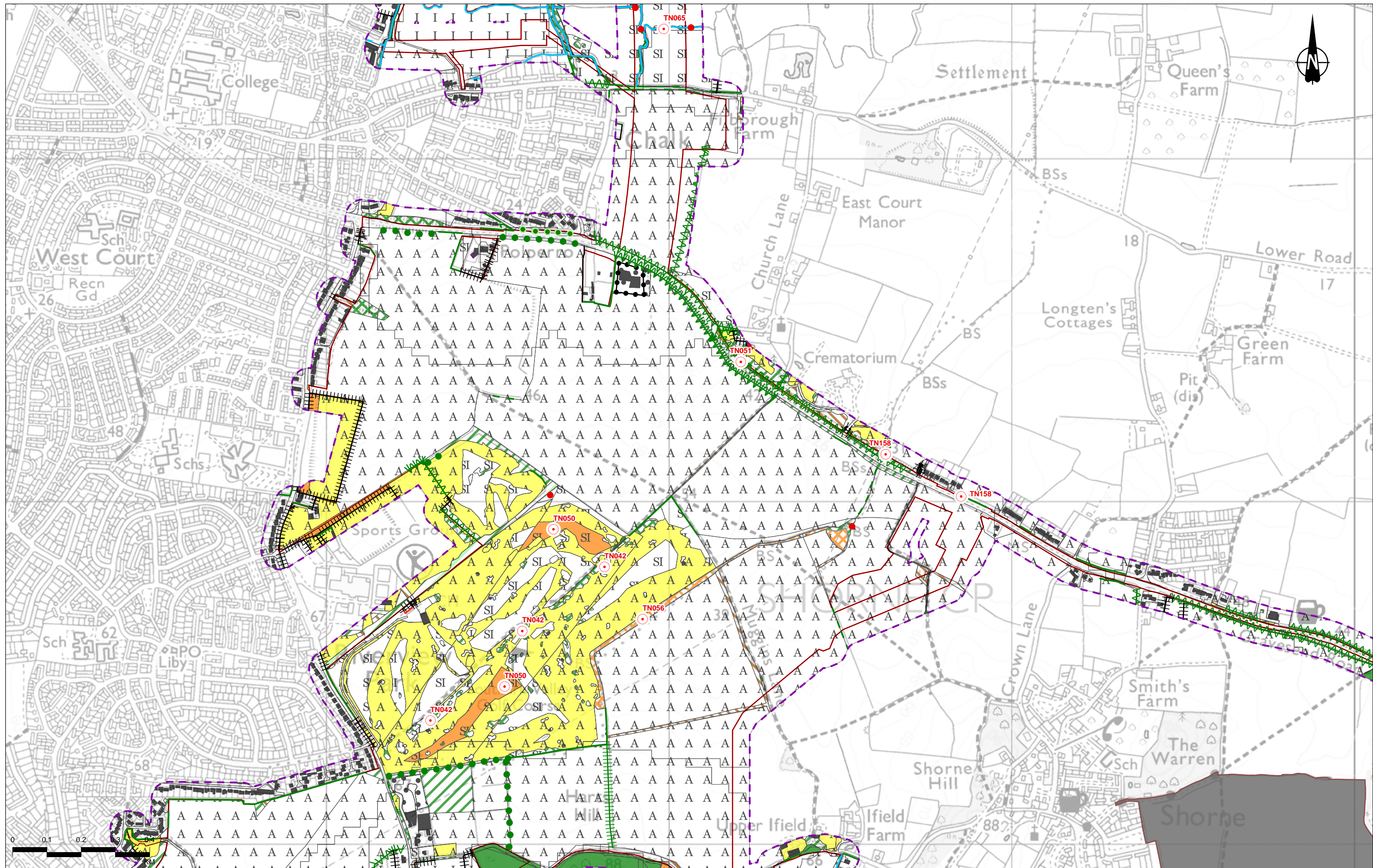
Z:\Environment\Environmental Statement\08_Terrestrial Biodiversity\HE540039-CJV-EBD-SZP_EGNE00000000-DR-LE-50040 - 8.2 Phase 1 Map.aprx





Contains Ordnance Survey data. © Crown copyright and database rights 2022. Ordnance Survey 100030649

Rev	Status	Rev. Date	Purpose of revision	Drawn	Chkd	Apprvd
P02	S8	06/10/2022	DCO Application	CD	SM	BF

Legend

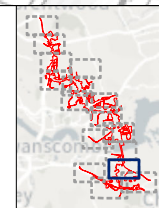
- Order Limits
- Compensation area for nitrogen deposition
- Plants and habitats study area
- Target note
- Invasive species



Client

 Project
LOWER THAMES CROSSING

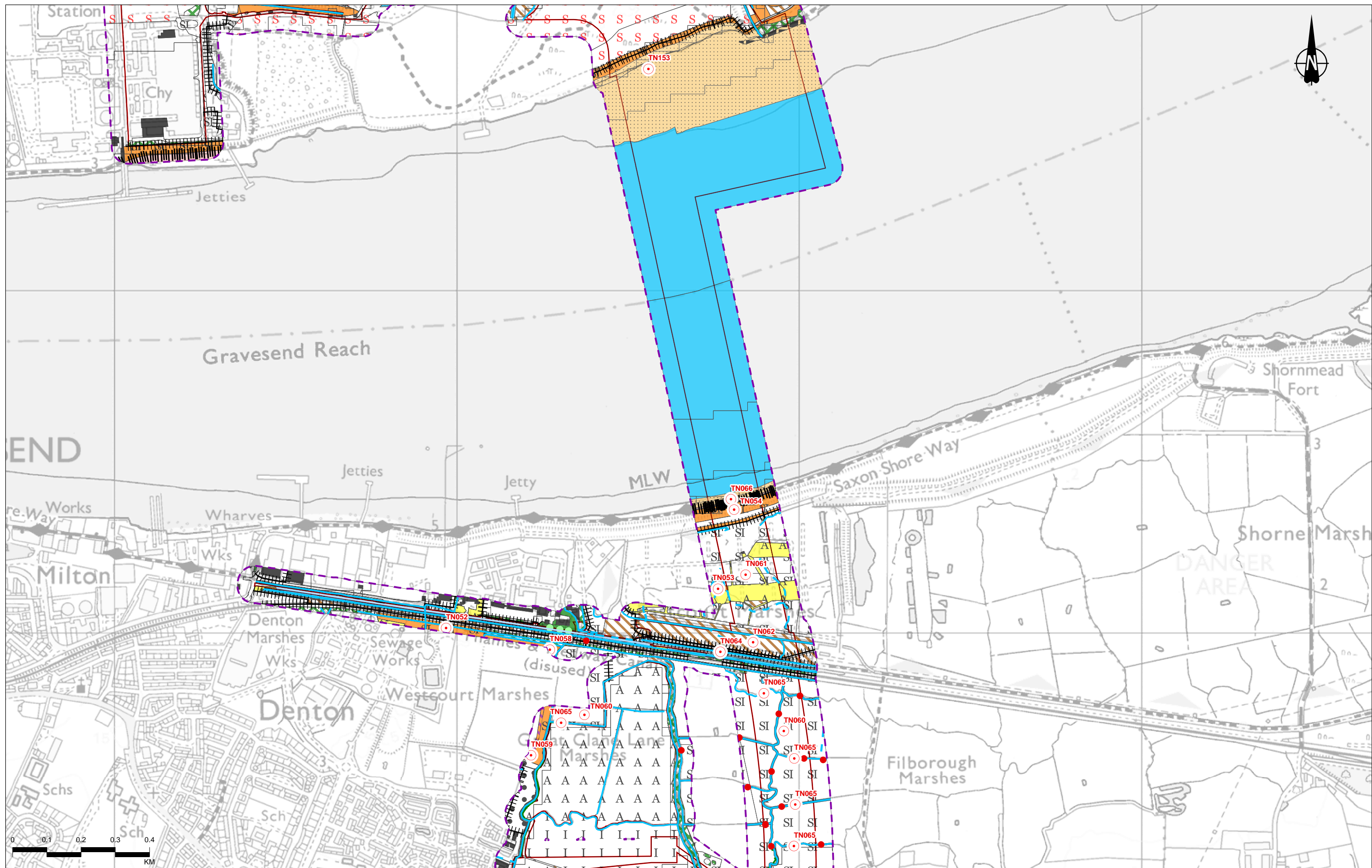
Status	DCO APPLICATION	Original Size	A3	Revision	P02
Application Document Number	TR010032/APP/6.2	Scale	1:10,000		
Drawing Title	Figure 8.2 - Phase 1 Habitat Map Page 4 of 16				
Drawing Number	HE540039-CJV-EBD-SZP_EGNE0000000-DR-LE-50040				



Contains Ordnance Survey data. © Crown copyright and database rights 2022. Ordnance Survey 100030649

Rev	Status	Rev. Date	Purpose of revision	Drawn	Chkd	Appr'd
P02	S8	06/10/2022	DCO Application	CD	SM	BF

- Legend**
- Order Limits
 - Compensation area for nitrogen deposition
 - Plants and habitats study area
 - Target note
 - Invasive species

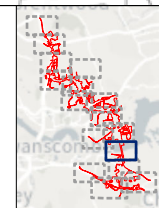

Client
national highways

Project
LOWER THAMES CROSSING

Status	DCO APPLICATION	Original Size	A3	Revision	P02
Application Document Number	TR010032/APP/6.2	Scale	1:10,000		
Drawing Title	Figure 8.2 - Phase 1 Habitat Map Page 5 of 16				
Drawing Number	HE540039-CJV-EBD-SZP_EGNE0000000-DR-LE-50040				

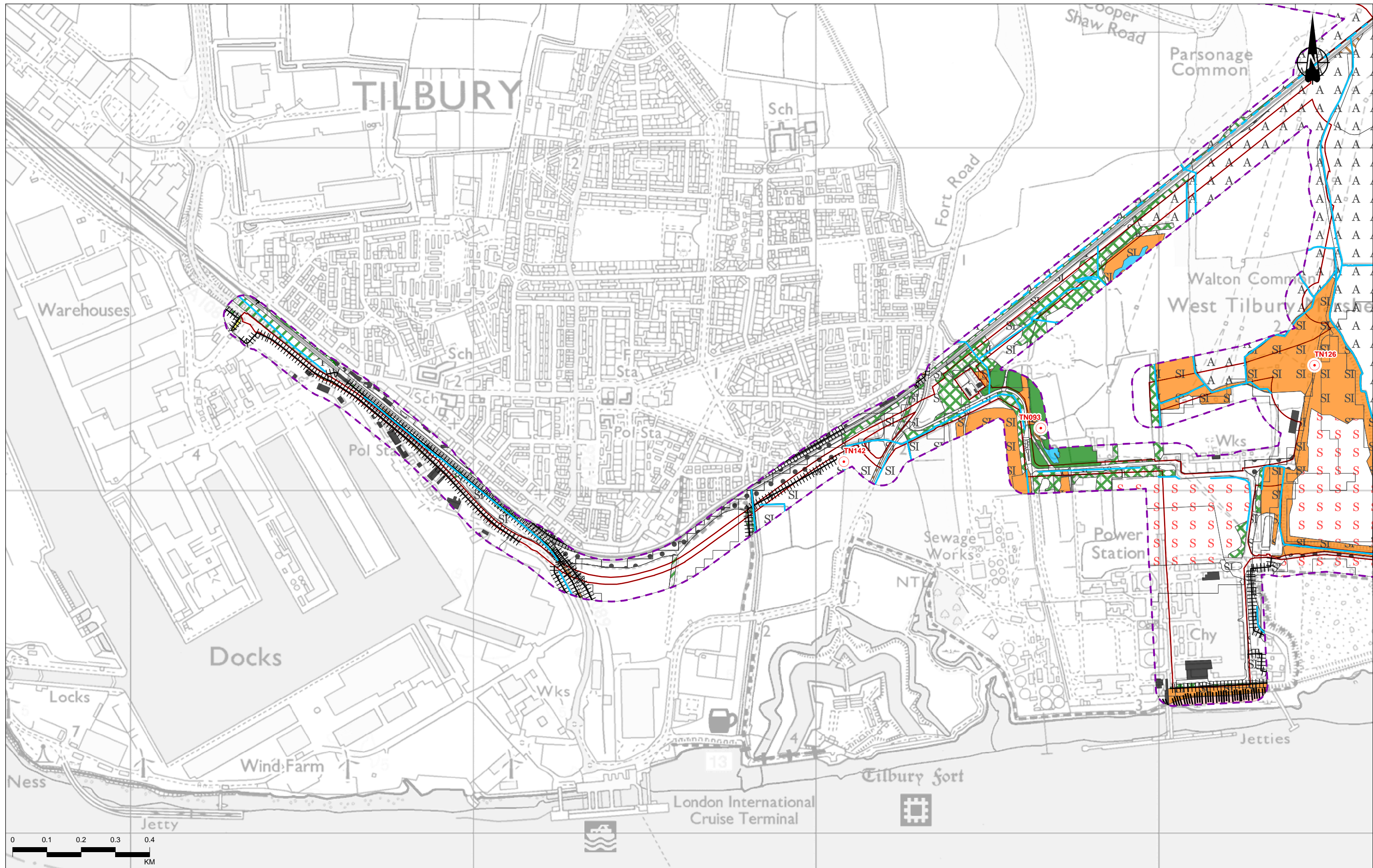

Contains Ordnance Survey data. © Crown copyright and database rights 2022. Ordnance Survey 100030649

Rev	Status	Rev. Date	Purpose of revision	Drawn	Chkd	Appr'd
P02	S8	06/10/2022	DCO Application	CD	SM	BF

- Legend**
- Order Limits
 - Compensation area for nitrogen deposition
 - Plants and habitats study area
 - Target note
 - Invasive species

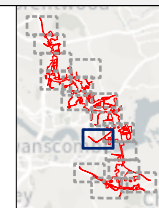

Client

 Project
LOWER THAMES CROSSING

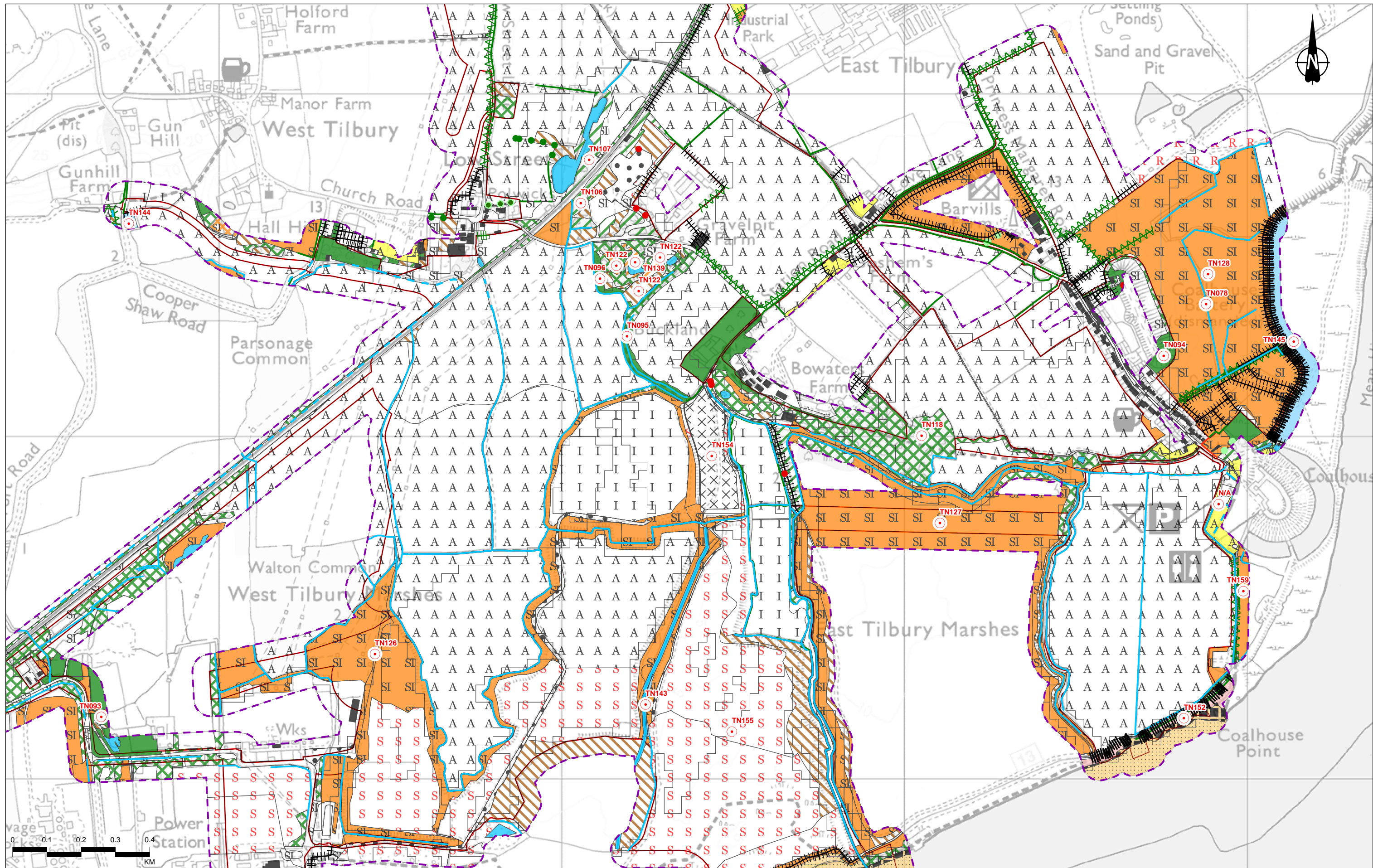
Status	DCO APPLICATION	Original Size	A3	Revision	P02
Application Document Number	TR010032/APP/6.2	Scale	1:10,000		
Drawing Title	Figure 8.2 - Phase 1 Habitat Map Page 6 of 16				
Drawing Number	HE540039-CJV-EBD-SZP_EGNE0000000-DR-LE-50040				



Contains Ordnance Survey data. © Crown copyright and database rights 2022. Ordnance Survey 100030649

Rev	Status	Rev. Date	Purpose of revision	Drawn	Chkd	Apprvd
P02	S8	06/10/2022	DCO Application	CD	SM	BF

- Legend**
- Order Limits
 - Compensation area for nitrogen deposition
 - Plants and habitats study area
 - Target note
 - Invasive species

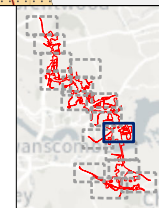

Client

 Project
LOWER THAMES CROSSING

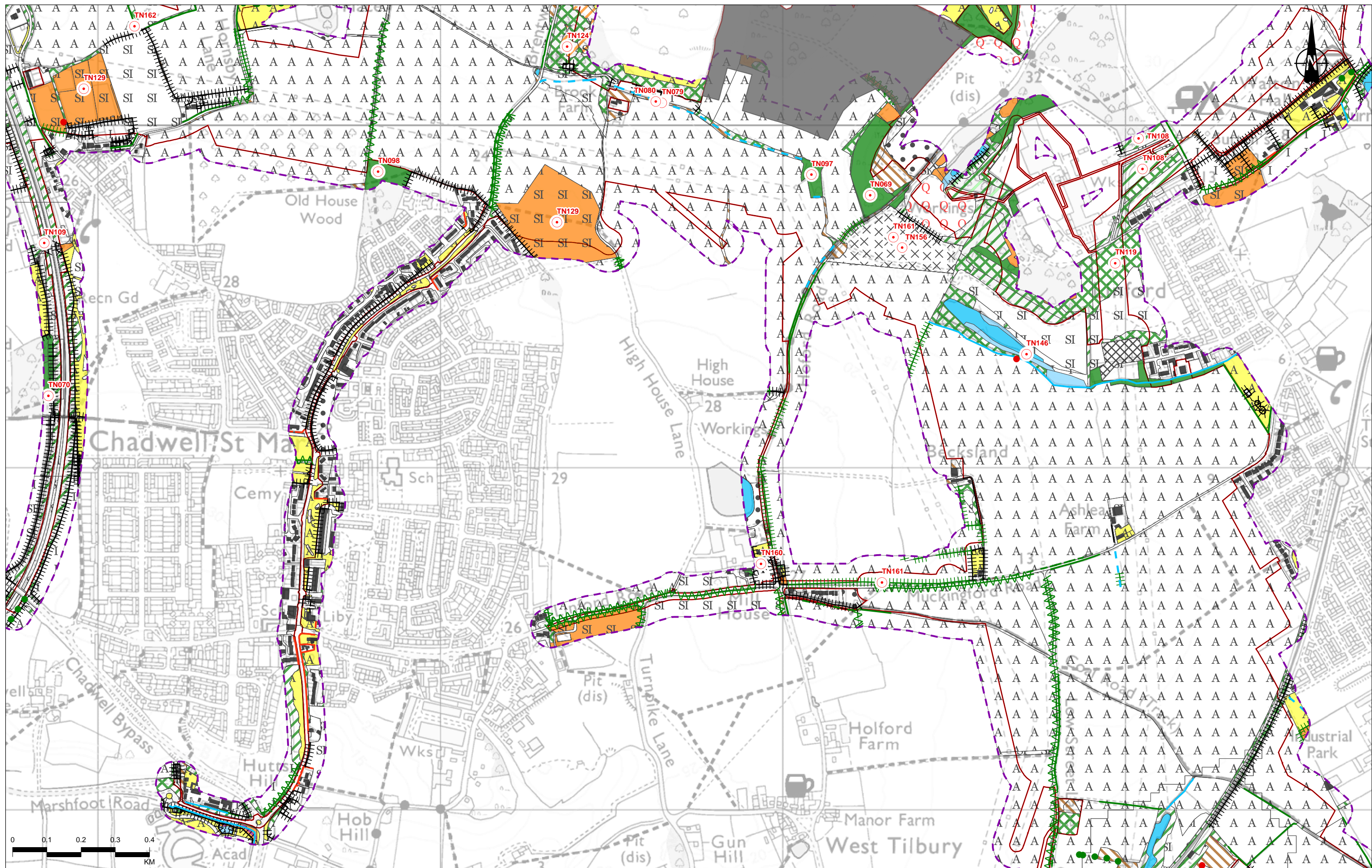
Status	DCO APPLICATION	Original Size	A3	Revision	P02
Application Document Number	TR010032/APP/6.2	Scale	1:10,000		
Drawing Title	Figure 8.2 - Phase 1 Habitat Map Page 7 of 16				
Drawing Number	HE540039-CJV-EBD-SZP_EGNE0000000-DR-LE-50040				



Contains Ordnance Survey data. © Crown copyright and database rights 2022. Ordnance Survey 100030649

Rev	Status	Rev. Date	Purpose of revision	Drawn	Chkd	Apprvd
P02	S8	06/10/2022	DCO Application	CD	SM	BF

Legend

- Order Limits
- Compensation area for nitrogen deposition
- Plants and habitats study area
- Target note
- Invasive species

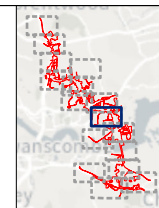

Client: **national highways**

Project: **LOWER THAMES CROSSING**

Status	DCO APPLICATION	Original Size	A3	Revision	P02
Application Document Number	TR010032/APP/6.2	Scale	1:10,000		
Drawing Title	Figure 8.2 - Phase 1 Habitat Map Page 8 of 16				
Drawing Number	HE540039-CJV-EBD-SZP_EGNE0000000-DR-LE-50040				



Contains Ordnance Survey data. © Crown copyright and database rights 2022. Ordnance Survey 100030649

Rev	Status	Rev. Date	Purpose of revision	Drawn	Chkd	Apprvd
P02	S8	06/10/2022	DCO Application	CD	SM	BF

Legend

- Order Limits
- Compensation area for nitrogen deposition
- Plants and habitats study area
- Target note
- Invasive species

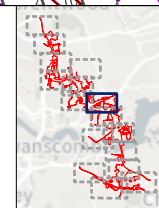

Client: **national highways**

Project: **LOWER THAMES CROSSING**

Status	DCO APPLICATION	Original Size	A3	Revision	P02
Application Document Number	TR010032/APP/6.2	Scale	1:10,000		
Drawing Title	Figure 8.2 - Phase 1 Habitat Map Page 9 of 16				
Drawing Number	HE540039-CJV-EBD-SZP_EGNE0000000-DR-LE-50040				

Z:\Environment\Environmental Statement\08_Terrestrial Biodiversity\HE540039-CJV-EBD-SZP_EGNE0000000-DR-LE-50040 - 8_2 Phase 1 Map.aprx

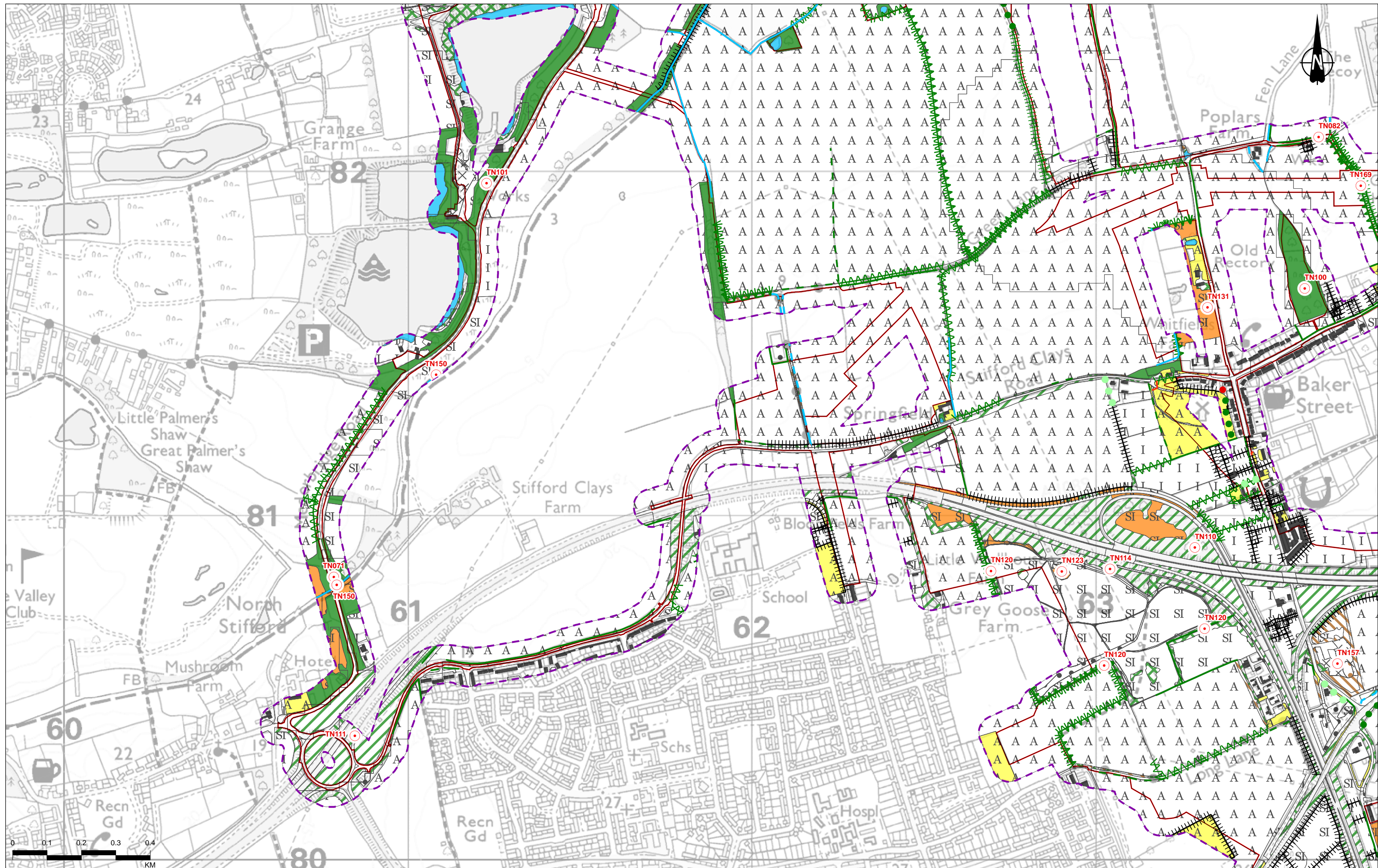

Contains Ordnance Survey data. © Crown copyright and database rights 2022. Ordnance Survey 100030649

Rev	Status	Rev. Date	Purpose of revision	Drawn	Chkd	Appvd
P02	S8	06/10/2022	DCO Application	CD	SM	BF

- Legend**
- Order Limits
 - Compensation area for nitrogen deposition
 - Plants and habitats study area
 - Target note
 - Invasive species

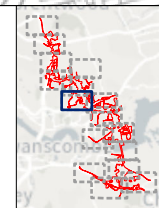

Client
national highways

Project
LOWER THAMES CROSSING

Status	DCO APPLICATION	Original Size	A3	Revision	P02
Application Document Number	TR010032/APP/6.2	Scale	1:10,000		
Drawing Title	Figure 8.2 - Phase 1 Habitat Map Page 10 of 16				
Drawing Number	HE540039-CJV-EBD-SZP_EGNE0000000-DR-LE-50040				

Z:\Environment\Environmental Statement\08_Terrestrial Biodiversity\HE540039-CJV-EBD-SZP_EGNE0000000-DR-LE-50040 - 8.2 Phase 1 Map.aprx

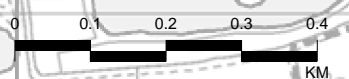
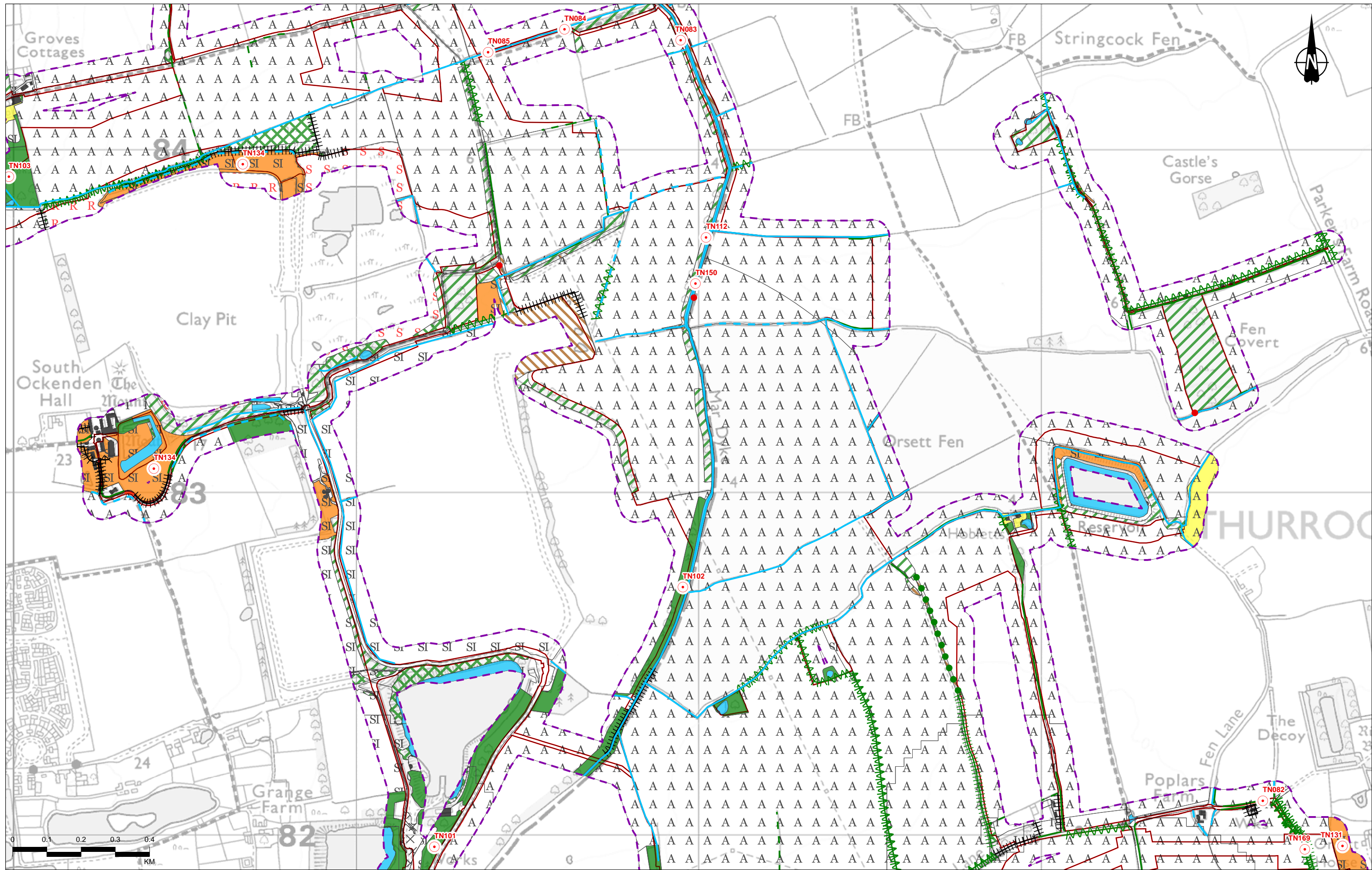

Contains Ordnance Survey data. © Crown copyright and database rights 2022. Ordnance Survey 100030649

Rev	Status	Rev. Date	Purpose of revision	Drawn	Chkd	Appr'd
P02	S8	06/10/2022	DCO Application	CD	SM	BF

- Legend**
- Order Limits
 - Compensation area for nitrogen deposition
 - Plants and habitats study area
 - Target note
 - Invasive species

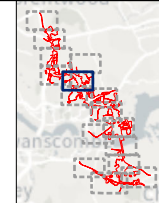

Client: **national highways**

Project: **LOWER THAMES CROSSING**

Status	DCO APPLICATION	Original Size	A3	Revision	P02
Application Document Number	TR010032/APP/6.2	Scale	1:10,000		
Drawing Title	Figure 8.2 - Phase 1 Habitat Map Page 11 of 16				
Drawing Number	HE540039-CJV-EBD-SZP_EGNE0000000-DR-LE-50040				

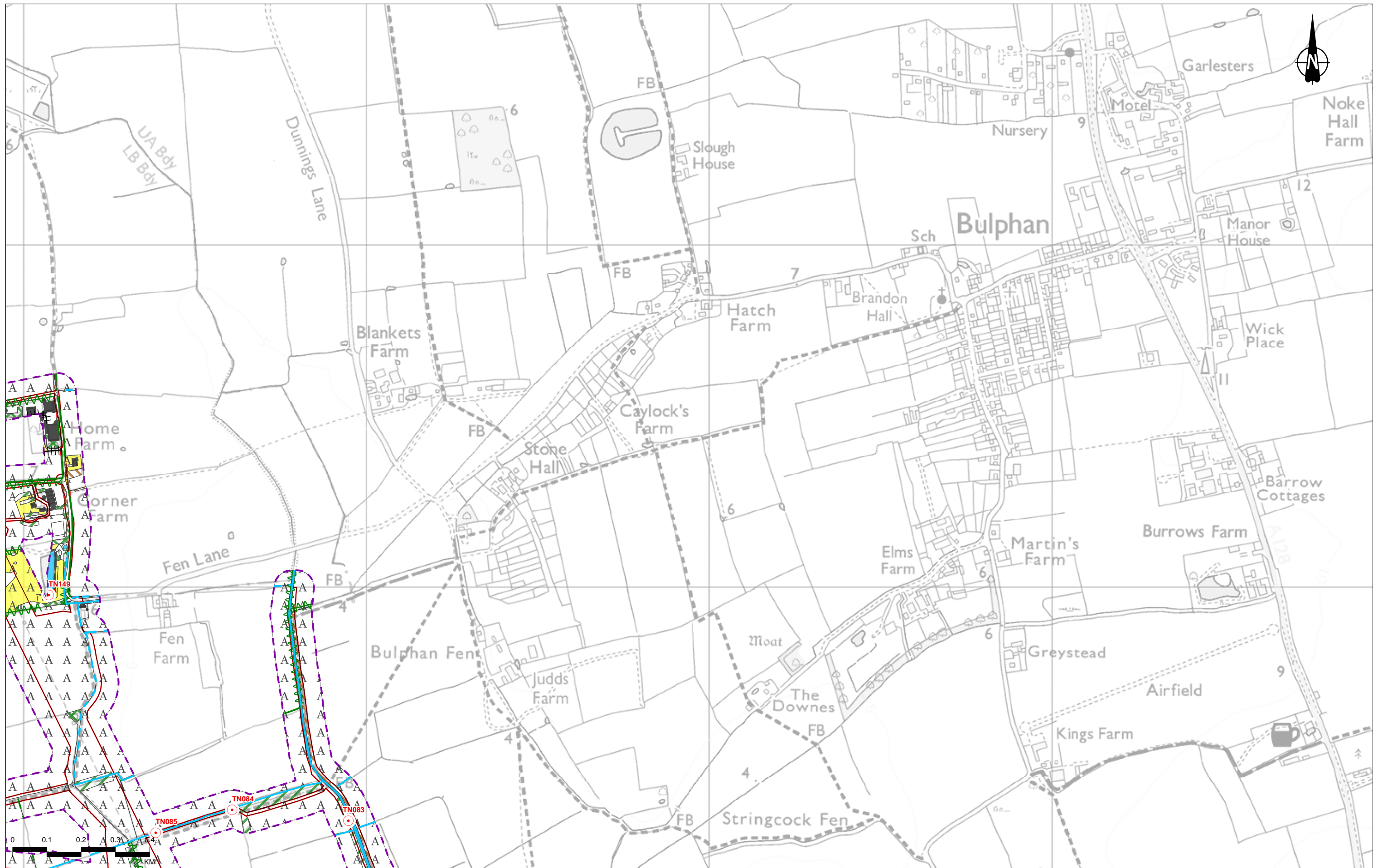

Contains Ordnance Survey data. © Crown copyright and database rights 2022. Ordnance Survey 100030649

Rev	Status	Rev. Date	Purpose of revision	Drawn	Chkd	Apprv'd
P02	S8	06/10/2022	DCO Application	CD	SM	BF

- Legend**
- Order Limits
 - Compensation area for nitrogen deposition
 - Plants and habitats study area
 - Target note
 - Invasive species

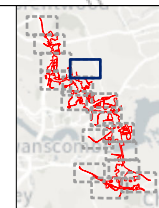

Client

 Project
LOWER THAMES CROSSING

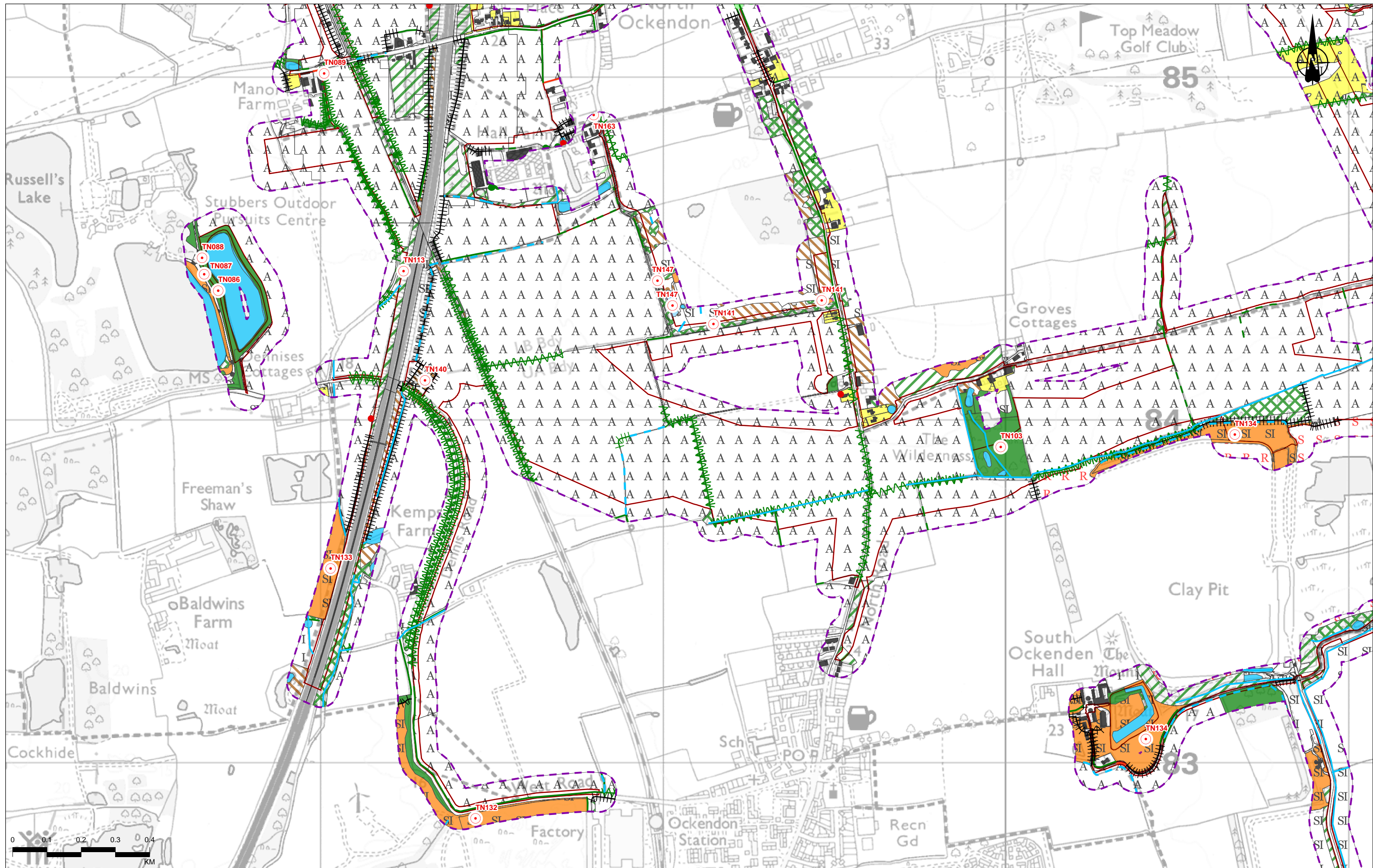
Status	DCO APPLICATION	Original Size	A3	Revision	P02
Application Document Number	TR010032/APP/6.2	Scale	1:10,000		
Drawing Title	Figure 8.2 - Phase 1 Habitat Map Page 12 of 16				
Drawing Number	HE540039-CJV-EBD-SZP_EGNE0000000-DR-LE-50040				

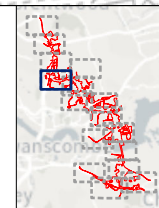

- Legend**
- Order Limits
 - Compensation area for nitrogen deposition
 - Plants and habitats study area
 - Target note
 - Invasive species

Rev	Status	Rev. Date	Purpose of revision	Drawn	Chkd	Appr'd
P02	S8	06/10/2022	DCO Application	CD	SM	BF



Client

 Project
LOWER THAMES CROSSING

Status	DCO APPLICATION	Original Size	A3	Revision	P02
Application Document Number	TR010032/APP/6.2	Scale	1:10,000		
Drawing Title	Figure 8.2 - Phase 1 Habitat Map Page 13 of 16				
Drawing Number	HE540039-CJV-EBD-SZP_EGNE0000000-DR-LE-50040				

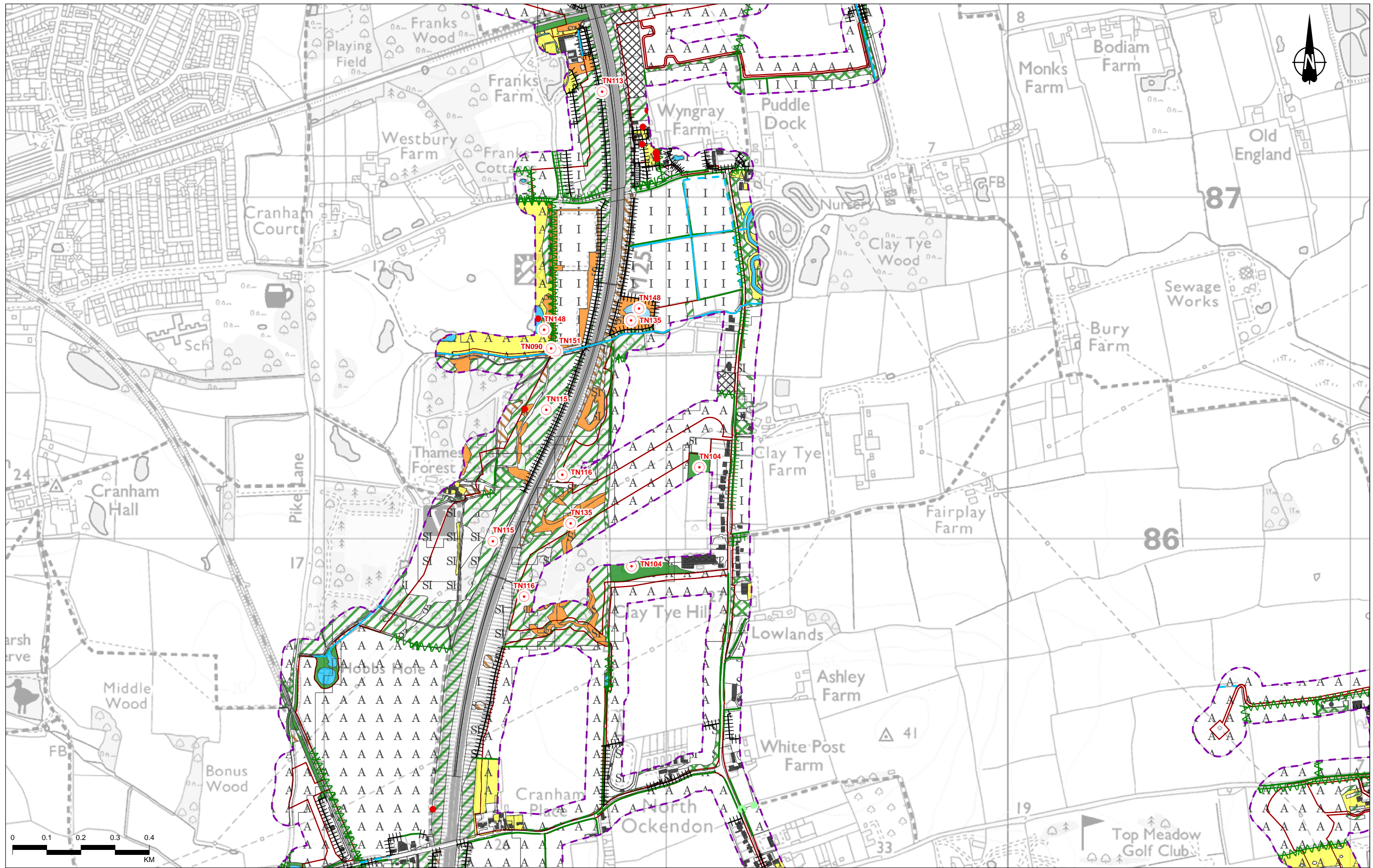

Contains Ordnance Survey data. © Crown copyright and database rights 2022. Ordnance Survey 100030649

Rev	Status	Rev. Date	Purpose of revision	Drawn	Chkd	Apprvd
P02	S8	06/10/2022	DCO Application	CD	SM	BF

Legend

- Order Limits
- Compensation area for nitrogen deposition
- Plants and habitats study area
- Target note
- Invasive species

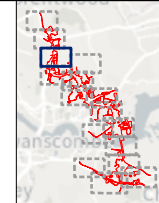

Client
national highways

Project
LOWER THAMES CROSSING

Status	DCO APPLICATION	Original Size	A3	Revision	P02
Application Document Number	TR010032/APP/6.2	Scale	1:10,000		
Drawing Title	Figure 8.2 - Phase 1 Habitat Map Page 14 of 16				
Drawing Number	HE540039-CJV-EBD-SZP_EGNE0000000-DR-LE-50040				

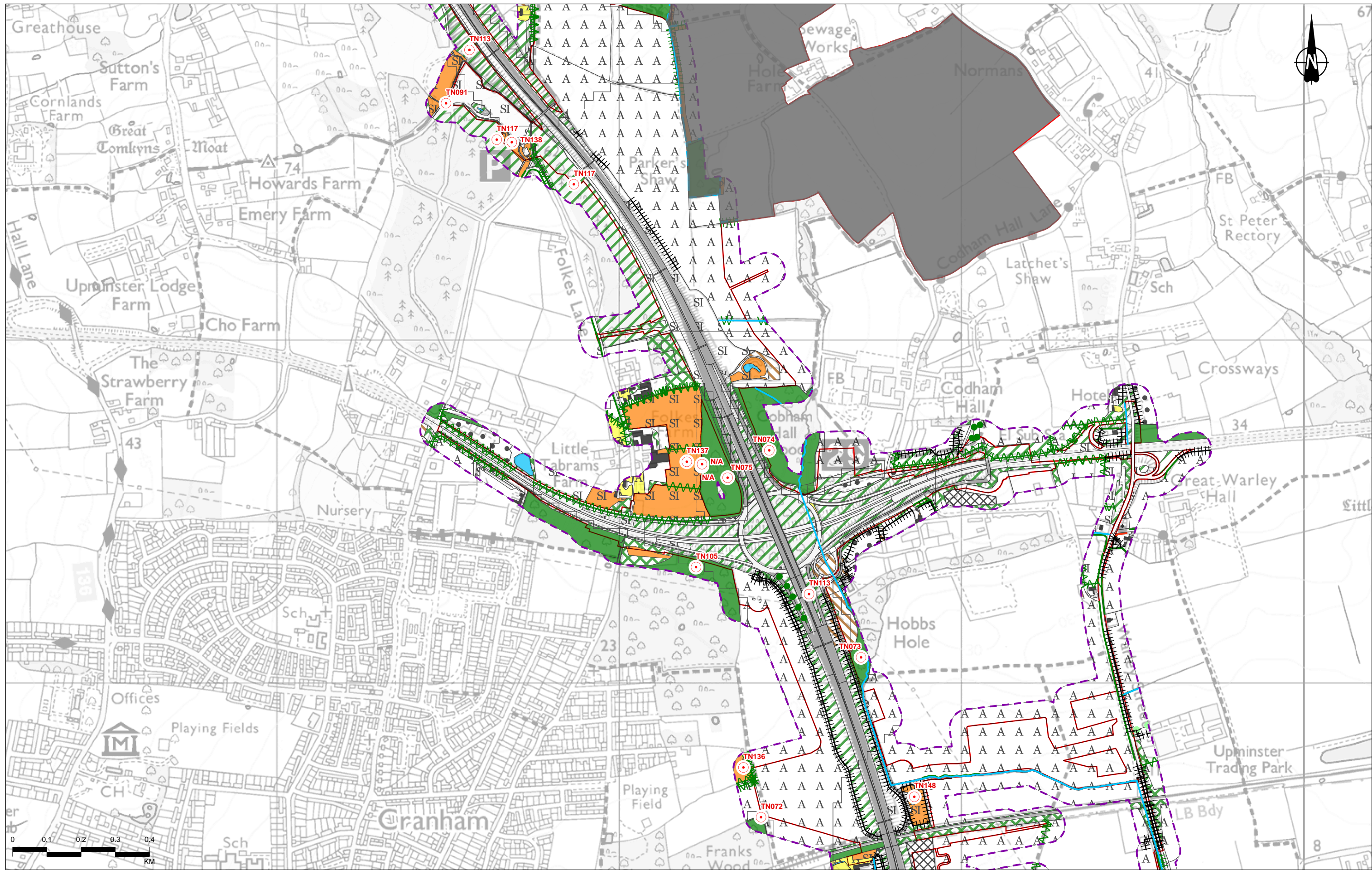

Contains Ordnance Survey data. © Crown copyright and database rights 2022. Ordnance Survey 100030649

Rev	Status	Rev. Date	Purpose of revision	Drawn	Chkd	Apprvd
P02	S8	06/10/2022	DCO Application	CD	SM	BF

- Legend**
- Order Limits
 - Compensation area for nitrogen deposition
 - Plants and habitats study area
 - Target note
 - Invasive species

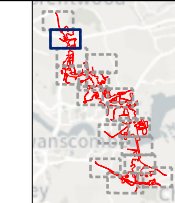

Client

 Project
LOWER THAMES CROSSING

Status	DCO APPLICATION	Original Size	A3	Revision	P02
Application Document Number	TR010032/APP/6.2	Scale	1:10,000		
Drawing Title	Figure 8.2 - Phase 1 Habitat Map Page 15 of 16				
Drawing Number	HE540039-CJV-EBD-SZP_EGNE0000000-DR-LE-50040				

Z:\Environment\Environmental Statement\08_Terrestrial Biodiversity\HE540039-CJV-EBD-SZP_EGNE0000000-DR-LE-50040 - 8.2 Phase 1 Map.aprx

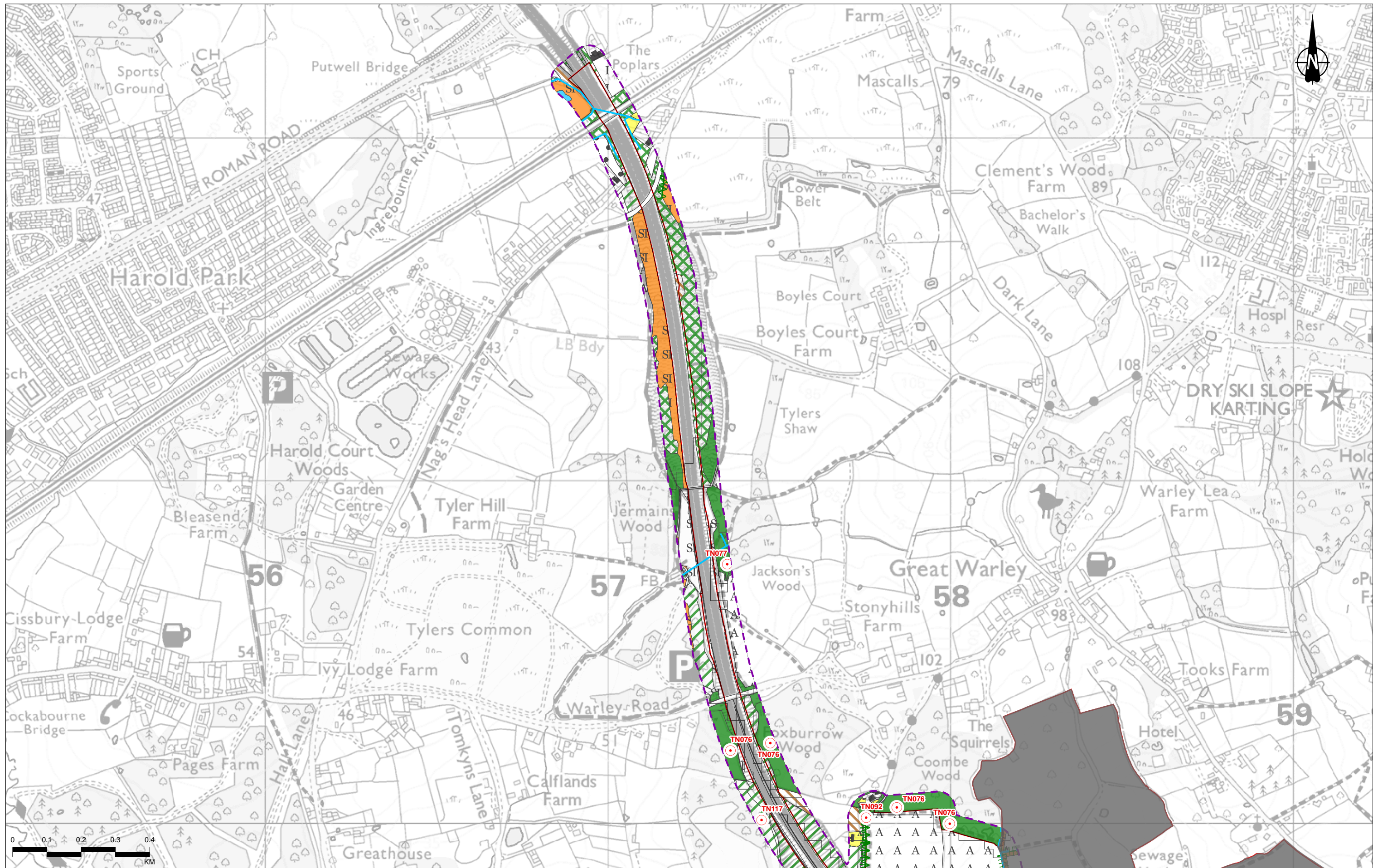

Contains Ordnance Survey data. © Crown copyright and database rights 2022. Ordnance Survey 100030649

Rev	Status	Rev. Date	Purpose of revision	Drawn	Chkd	Appvd
P02	S8	06/10/2022	DCO Application	CD	SM	BF

- Legend**
- Order Limits
 - Compensation area for nitrogen deposition
 - Plants and habitats study area
 - Target note
 - Invasive species

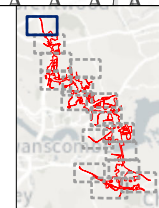

Client
national highways

Project
LOWER THAMES CROSSING

Status	DCO APPLICATION	Original Size	A3	Revision	P02
Application Document Number	TR010032/APP/6.2	Scale	1:10,000		
Drawing Title	Figure 8.2 - Phase 1 Habitat Map Page 16 of 16				
Drawing Number	HE540039-CJV-EBD-SZP_EGNE0000000-DR-LE-50040				

Z:\Environment\Environmental Statement\08_Terrestrial Biodiversity\HE540039-CJV-EBD-SZP_EGNE0000000-DR-LE-50040 - 8.2 Phase 1 Map.aprx

If you need help accessing this or any other National Highways information, please call **0300 123 5000** and we will help you.

© Crown copyright 2022.

You may re-use this information (not including logos) free of charge in any format or medium, under the terms of the Open Government Licence. To view this licence:

visit www.nationalarchives.gov.uk/doc/open-government-licence/

write to the **Information Policy Team, The National Archives, Kew, London TW9 4DU**, or email psi@nationalarchives.gsi.gov.uk.

Mapping (where present): © Crown copyright and database rights 2022 OS 100030649. You are permitted to use this data solely to enable you to respond to, or interact with, the organisation that provided you with the data. You are not permitted to copy, sub-license, distribute or sell any of this data to third parties in any form.

If you have any enquiries about this publication email info@nationalhighways.co.uk or call **0300 123 5000***.

*Calls to 03 numbers cost no more than a national rate call to an 01 or 02 number and must count towards any inclusive minutes in the same way as 01 and 02 calls. These rules apply to calls from any type of line including mobile, BT, other fixed line or payphone. Calls may be recorded or monitored.

Printed on paper from well-managed forests and other controlled sources when issued directly by National Highways.

Registered office Bridge House, 1 Walnut Tree Close, Guildford GU1 4LZ

National Highways Company Limited registered in England and Wales number 09346363